

Ambient lighting is provided by louvred luminaires for fluorescent lamps arranged parallel to the window. The lighting layout is workplace-related, with lower illuminance in the circulation area between the doors. The wide-angle luminaires make for enhanced contrast rendition; the direct light component is reduced by the linear prismatic lens.

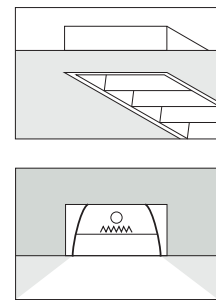

Recessed louvered luminaires for fluorescent lamps.

Integral direct-indirect luminaires for fluorescent lamps and track-mounted spotlights mounted on a light structure suspended in the space. The ambient lighting is workplace-related and is produced by the luminaires for fluorescent lamps. The spotlights are used to accent points of interest on the walls.

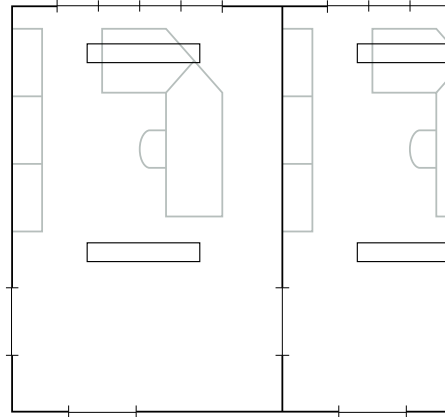
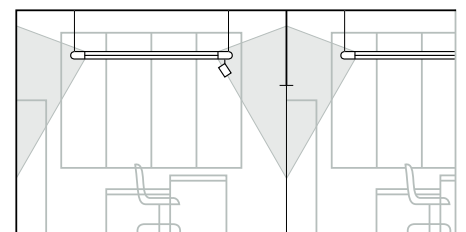
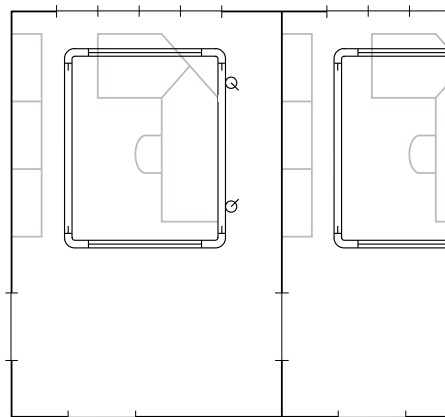

Suspended light structure with integral direct-indirect luminaires for fluorescent lamps and integral track-mounted spotlights.

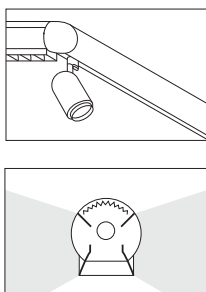

General lighting is provided by recessed secondary reflector luminaires. The ratio of direct and indirect light and glare limitation can be controlled by the appropriate choice of luminaires, which in turn produces the required atmosphere.

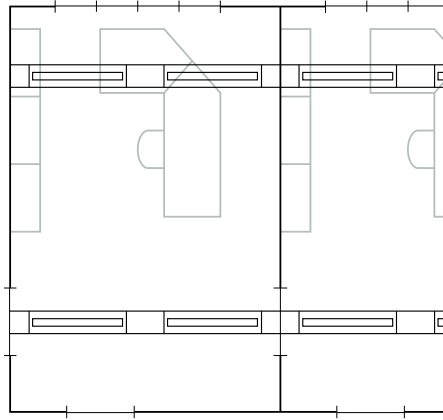

Secondary reflector luminaire for recessed mounting for fluorescent lamps.

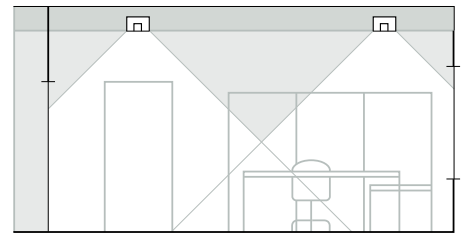
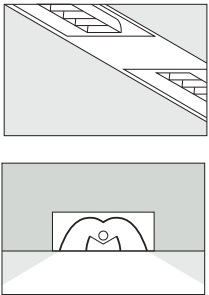

Ambient lighting is provided by a precisely positioned group of four downlights with cross-blade louvres for compact fluorescent lamps.

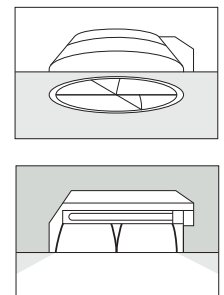
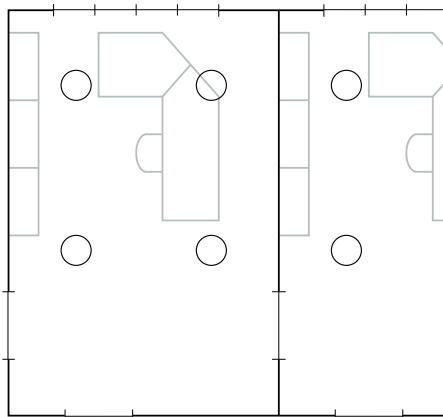

Recessed downlight with cross-blade louvre for compact fluorescent lamps.

Office lighting using louvred luminaires for compact fluorescent lamps. A linear prismatic lens can be inserted above the cross-blade louvre. This produces batwing light distribution, which in turn leads to enhanced contrast rendition.

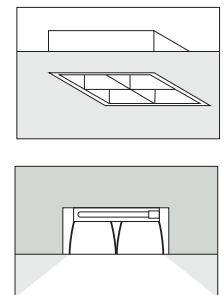
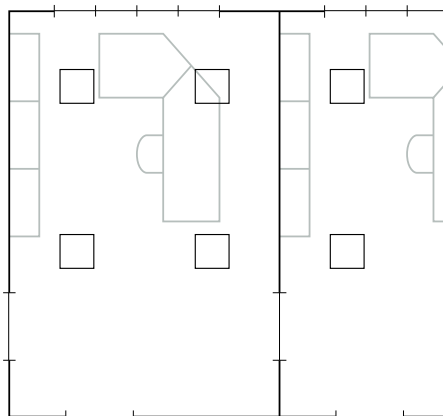

Recessed louvred luminaire for compact fluorescent lamps.